

Hants County  
Nova Scotia

401500

402000

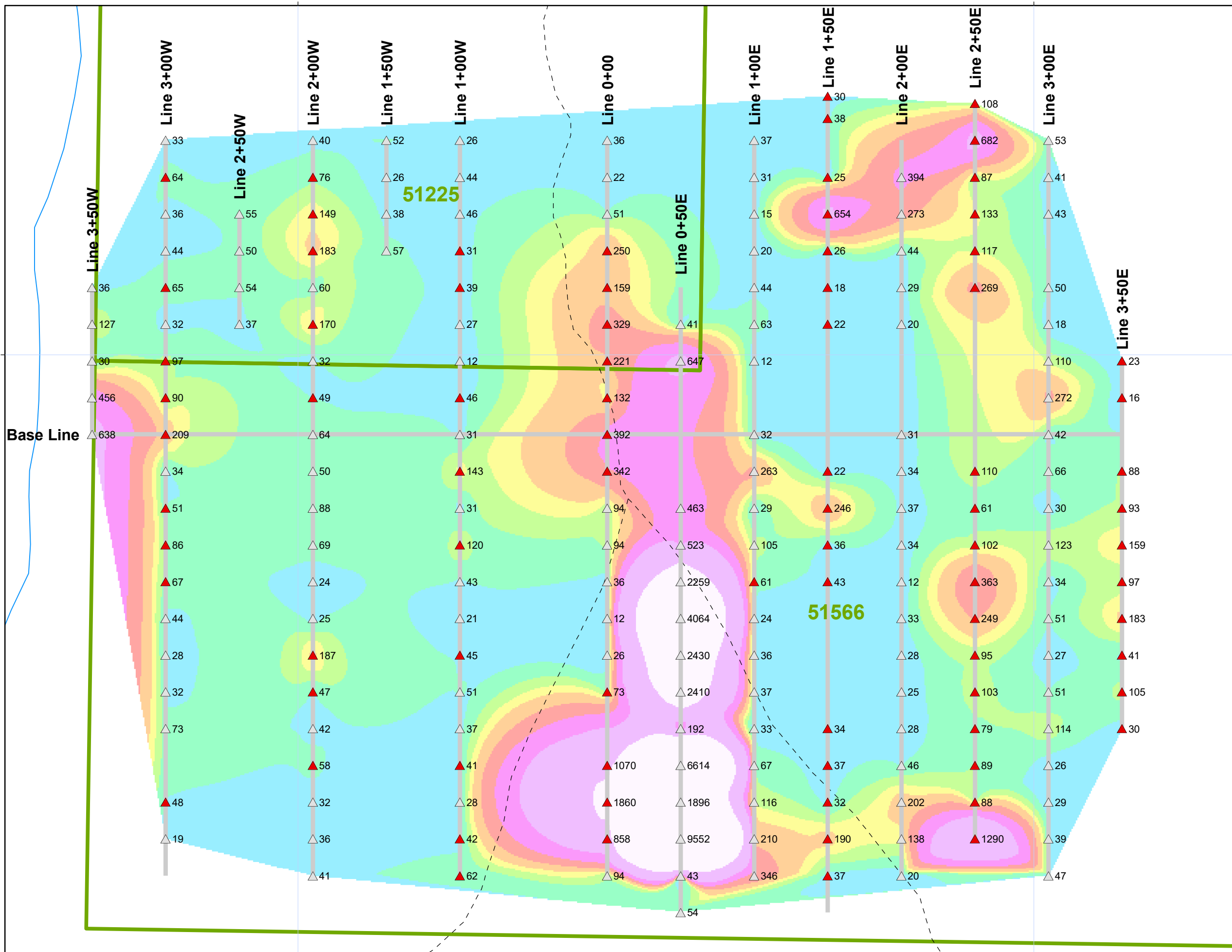

401500

402000

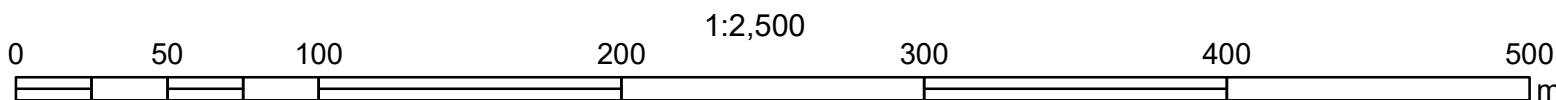
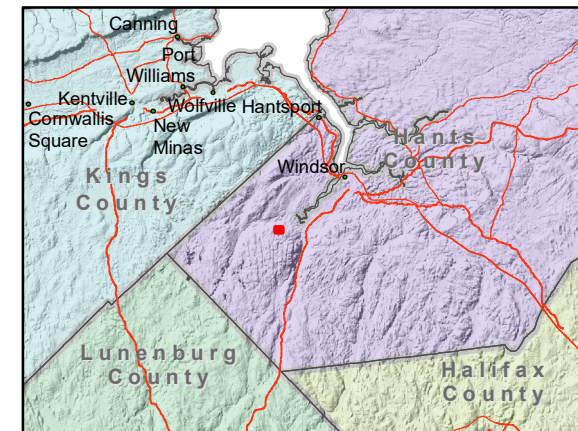

Figure 2018- SOILS-Pb-all  
1:2500  
Castle Frederick Project  
All Pb ppm to date  
XRF and ActLab  
2018-02-13



Legend

NS DNR Claims (2017-05-08)

Pb ppm;  
type  
 ActLab - Min Detection 3 ppm  
 XRF1; XRF2; XRF3

Pb  
ppm  
 12  
 12.1 - 49.4  
 49.5 - 86.8  
 86.9 - 124.2  
 124.3 - 161.6  
 161.7 - 236.5  
 236.6 - 348.7  
 348.8 - 535.8  
 535.9 - 1,358.8  
 1,358.9 - 9,552  
 theoretical grid  
 resource roads  
**Hydrography**  
 Open water  
 Swamp  
 Watercourse

Sources:  
NTS 21H08  
Base Mapping:  
Geonova (Service Nova Scotia & Municipal Relations)  
Mineral Licence, Tract Data and Historic DDH data:  
Nova Scotia Department of Natural Resources

Geodetic Data:  
Earth Datum, North American 1983  
UTM Zone, 20